

Ventilator LAF units are manufactured by Scanlaf

ScanLaf is a Danish company specialising in the development, production and sales of laboratory and industrial equipments encompassing the following technologies:

Laminar Flow, Vacuum & Cooling

All our staff have a long and successful heritage from the well known Heto-Holten A/S™ company from which today's portfolio of equipments have been developed.

The new ScanLaf range of equipments are the successors to this legacy and a majority of the accessories provided today are compatible with instrumentation you may already have in your laboratory.

ScanLaf A/S presents to you probably the best in Class 2 and laminar flow Cabinets and technology available today. Together with the ScanVac range of world class Freeze Dryers, Speed Vacuum Concentrators and cooling baths.

Industrial Laminar Flow

Clean Air installations, incorporating down-flow and recirculating down flow modules for powder or animal handling are part of our customised solutions for industrial or laboratory applications. Glove-Boxes and Air Shower constructions, on a bespoke basis, are our force and expertise that is available in consultation with our Technical Team.

Our Service Organisation and network of selected distributors offer complete back-up and support as well as service.

We look forward to co-operate with you.

™ trade name/mark owned by Thermo Corporation.



TITAN
ALMOST Rocket Science



Clean Air Cabinets

Designed for
PCR and applications
requiring Sterility better
than Class 100

TITAN

ALMOST Rocket Science

Introducing the Titan and Titan PCR...rocket power to a clean work station...
Titan and Titan PCR: Ultra clean environment, low Running costs, slim design, personal work stations.
Designed for most applications where sterility and clean air are the essentials.

Titan

Titan is a true vertical laminar flow cabinet providing sterility and portability, easy to place on existing worktables or benches and can be easily removed and stored when not in use.

True laminar airflow with sterile air better than class 100 eliminates the risk of contamination of the samples and avoids cross-contamination whilst working. The high work opening front, the low noise level and excellent lighting with clear side windows in polycarbonate makes the Titan a pleasant work station for the operators. The low energy consumption and the digital control system combines convenience with savings on energy and expensive HEPA-filters. Excellent for microbiological work, cleansing the environment of allergens and particles down to 1 microns for use in the electronics and contact lens manipulation and many other applications where a clean air environment is essential. Optional ULPA-filters can be fitted as required by the electronics industry and for nanotechnology applications.

The optional electrically operated elevation stand makes the Titan an excellent work bench with excellent ergonomics for correct operator posture for either a sitting or standing position whilst working.

Specifications

| Titan cat.no. 9.100.010.001 | Unit | |
|-----------------------------|-------------------|---|
| Material | | Pressure chamber in polyester coated steel. Table top, front, side and back wall in strong polycarbonate. |
| External dimensions (DxWxH) | mm | 336x626x975 |
| Working chamber (DxWxH) | mm | 313x574x530 |
| Downflow, (0,40 m/s) | m ³ /h | 300 |
| Energy consumption/Effect | W | 90 |
| Sound level | dB(A) | 52 |
| HEPA filter, EN 1822, H-14 | | 99,995 % MPPS |
| Prefilters, quality EU 3 | | ASHRAE 83 |
| Weight | kg | 25 |
| Accessories | | Electrical elevation stand working heights from 75 cm to 105 cm |

| Spareparts | For Titan and Titan PCR |
|---------------|--|
| 9.000.010.006 | Electrical elevation stand 700 -1000 mm for Titan, Titan PCR, Atlas and Sirius |
| 9.000.019.009 | Prefilter for Titan and Titan PCR |
| 9.000.019.011 | Spare HEPA H-14 filter for Titan, Titan PCR, HV-mini models, Atlas and Sirius |

Titan

Airflow Pattern
Titan and Titan PCR

Easy operation

Easy prefilter
exchange

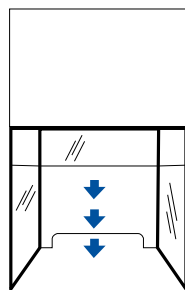

Titan PCR

Titan PCR is compact work station and a true vertical laminar flow cabinet with built in UV-light and is easy to place on existing work tables and can be easily removed and stored when not in used.

UV-light ensures inactivation of RNA/DNA contaminants within a few minutes and is the safe way to reliable and consistent results during daily PCR procedures. True laminar air-flow with sterile air better than class 100 eliminates the risk of cross-contamination whilst working, ensures no contamination of the chamber, which allows the UV light to work efficiently, being directed closely towards the work table - full product protection over the entire working area can be valuable in other work as well as for PCR procedures.

The high work opening front, the low noise level and excellent lighting with clear side windows in polycarbonate and built in lighting, makes the Titan PCR a pleasant work station for the operator. The low energy consumption and the digital control system combines convenience with savings on energy and expensive UV- light tubes and HEPA-filters. The combination of UV-light and sterile air together with an easy to clean chamber in stainless steel, large work opening and maximum operator comfort make the Titan PCR a the best choice.

An optional electrical elevation stand will make an excellent work bench with excellent ergonomics for correct operator posture for either a sitting or standing position whilst working.

Specifications

| Titan PCR cat.no. 9.100.010.011 | Unit | Unit |
|---------------------------------|-------------------|--|
| Material | | Pressure chamber in polyester coated steel, Table top in stainless steel 304 Front, side and backwall UV-resistant in strong polycarbonate. |
| External dimensions (DxWxH) | mm | 336x626x975 |
| Working chamber (DxWxH) | mm | 313x574x530 |
| Downflow, (0,40 m/s) | m ³ /h | 300 |
| Energy consumption/Effect | W | 90 |
| Sound level | dB(A) | 52 |
| HEPA filter, EN 1822, H-14 | | 99,995 % MPPS |
| Prefilters, quality EU 3 | | ASHRAE 83 |
| UV-light intensity | | 254/15 |
| Weight | kg | 40 |
| Included | | Lightning, Digital display with Hour counter, digitally adjustable fan, alarm for power failure and air flow speed |
| Options | | Communication with CTS, dampers and extract blowers. USB-port with software for documentation purposes |

Slim design



Safety



Electrical elevation stand



Titan PCR

